

Theoretic Mass(kg)	Revision
Surface Area(dm <sup>2</sup> )	<b>A4</b>

Thread	Hole	Shaft

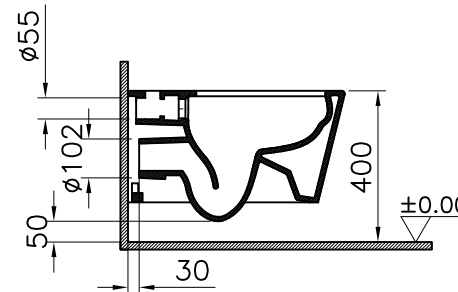
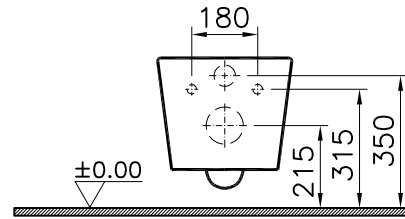
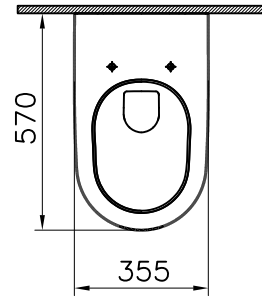

- \* Duvar kalınlığına göre ilave boru gerekebilir.
- \* Additional pipe may be required due to wall thickness
- \* Ein zusätzliches Ablaufrohr ist je nach Wandstärke erforderlich

1	1	Wall-hung WC pan	5176-0075	Ceramic	
item	Quantity	Part Name	Drawing No	Material	Material Class
		Series	Ceramic	Material	Material Class
		NEST	Wall-hung WC pan		
		Drawn By	Controlled By	Approved By	Date
		G.GULTER	R.HOCAOGLU	N.BALTACI	13.10.2015
				Drawing No	Scale
				5176	1/20
				VitrA®   ARTEMA®	

R.S	Description	Date	NAME