

| | | |
|--------------------------------|--|-----------|
| Theoretic Mass(kg) | | Revision |
| Surface Area(dm ²) | | A4 |

| | | |
|--------|------|-------|
| Thread | Hole | Shaft |
| | | |

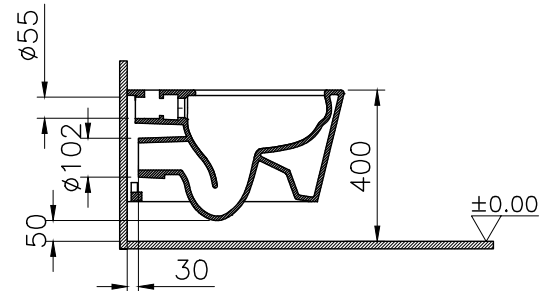
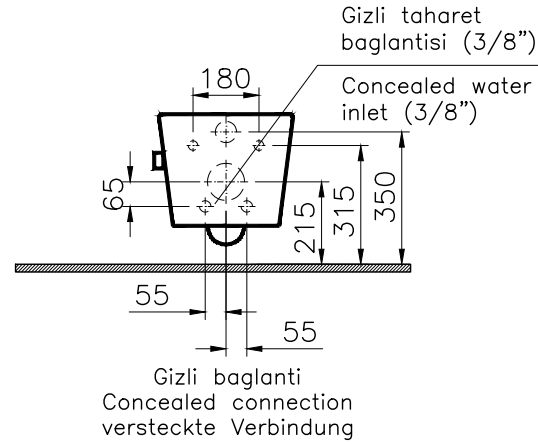
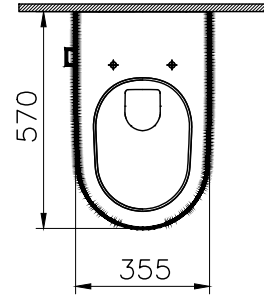

- * Duvar kalınlığına göre ilave boru gerekebilir.
- * Additional pipe may be required due to wall thickness
- * Ein zusätzliches Ablaufrohr ist je nach Wandstärke erforderlich

| | | | |
|-----|----------------------------------|------------|--------|
| 01 | Replaces Drawing date 13.10.2015 | 19.01.2017 | Gokhan |
| R.S | Description | Date | NAME |

| | | | | | |
|---|----------|------------------|------------------|------------|----------------|
| 1 | 1 | Wall-hung WC pan | 5176-1084 | Ceramic | |
| item | Quantity | Part Name | Drawing No | Material | Material Class |
| | | Series | Ceramic | Material | Material Class |
| | | NEST | Wall-hung WC pan | | |
| Drawn By | | Controlled By | Approved By | Date | Drawing No |
| G.GULTER | | R.HOCAOGLU | N.BALTACI | 13.10.2015 | 5176 |
| | | | | | Scale |
| | | | | | 1/20 |
| VitrA[®] ART[®]EMA | | | | | |

This drawing can only be used for the intended purposes. Unauthorized copying is strictly prohibited.

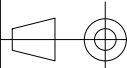

D
C
B
A

D
C
B
A

4 3 2 1